

PROPOSED
KALYADA MADDAPAN
AT MUDICHUR ROAD
TAMBARAM OF
SURVEY NO. 101/1970
PERUNGALATUR
VILLAGE, MADRAS.

MMDA (B.S.B.C. NO.
File No. 28733/1970
Scrutiny:
Part I
Part II

SPECIFICATIONS
FOUNDATION - R.C.C. COLUMN & P.
SUPER STRUCTURE - BRICE WORE IN
CEMENT MORTAR 1:2
ROOFING - 6" THK R.C.C. SLAB
IN 1:2:4 M.S.
PLASTERING - TO CEMENT MORTAR 1:2
FLOORING - MASIC FLOORING
WITH CEMENT MORTAR
WOOD WORK - T.W. MATU DOOR ALL
OTHER DOORS W.TUOSW
VENTILATORS ARE MADE
BY COUNTRY WOOD
WEATHERING COURSE - BRICE TALLY
LAID WITH LINE MORTAR
BELOW TWO LAYERS OF
PRESSO TILES

SCHEDULE OF JOUERNY

1. M.D. MATU DOOR	- 5'0" x 8'0"	244 x 244
2. P. DOOR	- 4'0" x 8'0"	122 x 244
3. D. DOOR	- 3'0" x 8'0"	91 x 244
4. D2 - DOOR	- 2'0" x 8'0"	76 x 244
5. W. WINDOW	- 6'0" x 5'0"	183 x 152
6. W.L. WINDOW	- 4'0" x 5'0"	123 x 152
7. V.I. VENTILATOR	- 2'0" x 2'0"	0.76 x 0.60
8. EFF. EXHAUSTED FAN	- 7'0" DIA	

AREA STATEMENT

GROUND FLOOR AREA	58.71	58.71
FIRST FLOOR AREA	49.07	49.07
PLOT AREA	20.072	186.54
TOTAL BUILTUP AREA	107.78	761.02
F.S.I. PROVIDED	0.52	
PLOT COVERAGE	28.7%	

LEGEND
PROPOSED - ●
ROAD - ○
BOUNDARY - ⊙
SEWER - ⊖

SCALE - 1" = 8'0"
DATE - 12.4.1974
DRAWN BY -
CHK BY -
OWNER SIGNATURE
P. 15.15 to 10.10.10.10
LICENCED SURVEYOR
MAHMOOD A.L.I. A. ARON A.L.L.
MEMBER COUNCIL OF ARCHITECTURE
C. A. 80/1574.

ARCHITECTS
K.K. ASSOCIATES
ARCHITECTS & ENGINEERS
NO. 12, 1ST STREET 4TH AVENUE
ASHOK NAGAR MADRAS. 83.

Planning Permit No. 23636/207/70
APPROVED
SUBJECT TO THE CONDITIONS IN
THIS OFFICE LETTER
No. 21/28733/1970
FOR MEMBER SECRETARY
MADRAS METROPOLITAN
DEVELOPMENT AUTHORITY
MADRAS - 600 008.

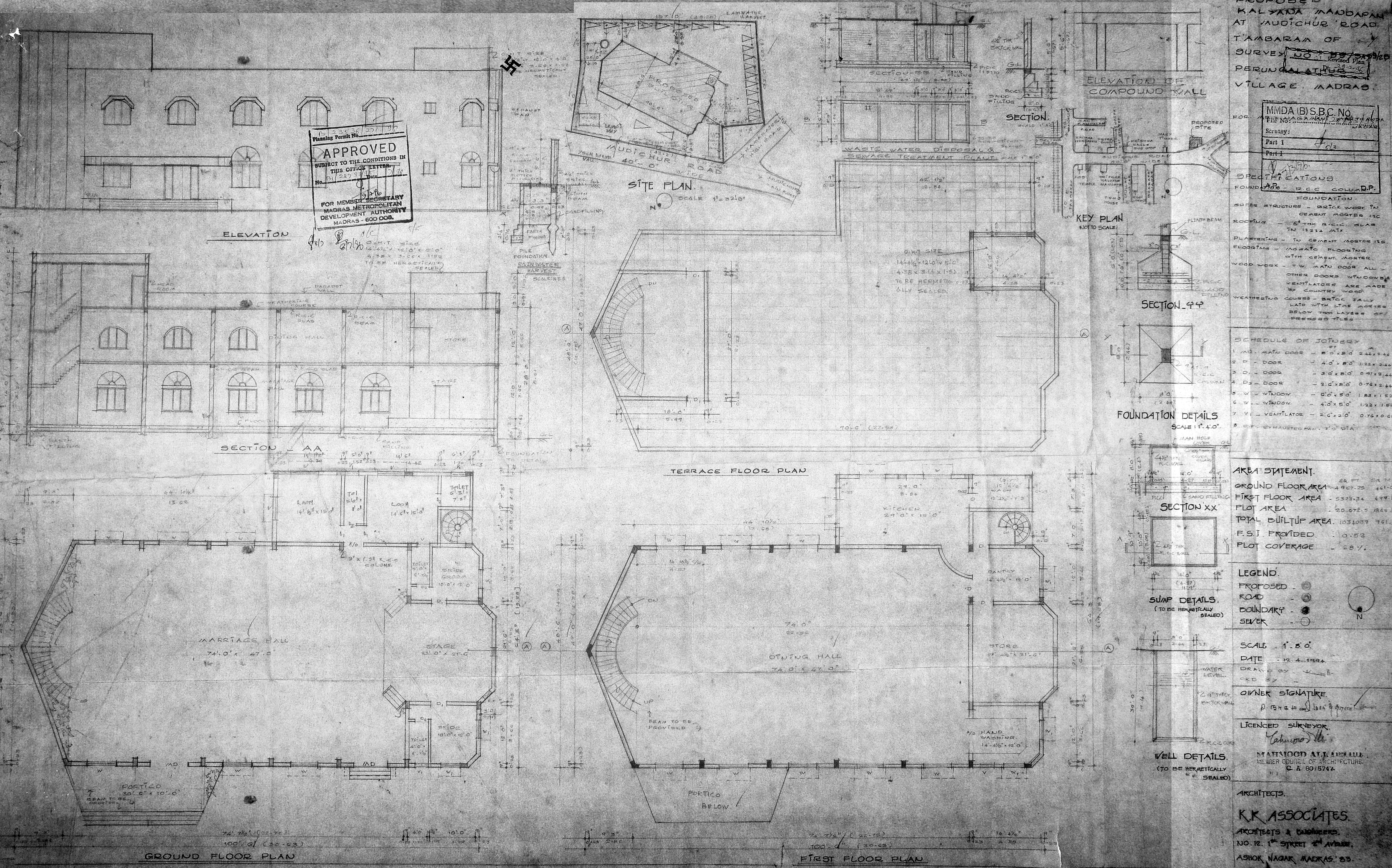

GROUND FLOOR PLAN

FIRST FLOOR PLAN